

**Hinge Series - HL019**

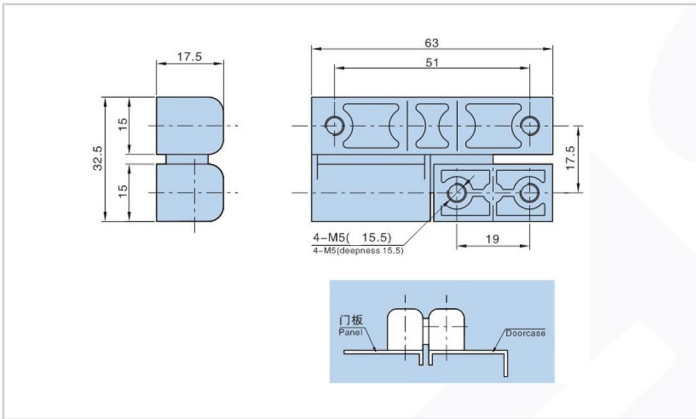

- **Features :**
  - Material: Zinc die-casting hinge
  - Remark: 180°hinge
- **Material :**
  - Zinc alloy
- **Surface treatment :**
  - Plastic Spray → Electroplate



➤ **Product Specification**

Characteristic	Product number and surface treatment				
	Black powder coated	Gray Spray paint	MaltBlack powder coated	Weight	Lot
Right hinge	HL019R.3	HL019R.2	HL019R.1	136	200
Left hinge	HL019L.3	HL019L.2	HL019L.1	136	200



**Manufacturer & Importer**

Panel Door Lock / Panel Door Hinges / Latches / Door Handles / Blind Rivet Nut / Mono-Bolt Rivets  
 Self Clinching Fasteners / Door gaskets / Fan Filters / Drawer Sliding Channel