

**Flat lock Serise - MS511**

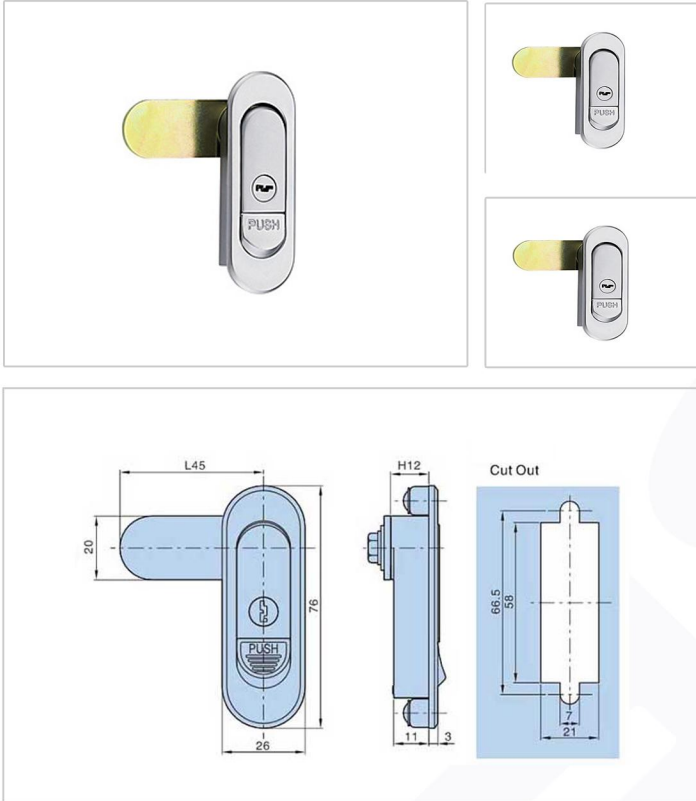

**Features :**

- Material:Zinc die-casting body,Zinc plating cam, fixing parts
- Finish: Gray chrome plating
- Panel thickness:1~4mm
- Remark: cam cutout 8×8

**Material :**

- Zinc alloy

**Surface treatment**

- Electroplate

**Product Specification**

Product Number	Weight	Lot
MS511	146	200

**Manufacturer & Importer**

Panel Door Lock / Panel Door Hinges / Latches / Door Handles / Blind Rivet Nut / Mono-Bolt Rivets  
 Self Clinching Fasteners / Door gaskets / Fan Filters / Drawer Sliding Chanel